

When using the Zip Charger, remove metallic cases and avoid placing metallic foreign objects on it (for example, keys, coins, batteries, or jewelry), as they may interfere with charging or become warm enough to cause discomfort or injury if your skin comes into contact with them. Don't place any item with an RFID tag (for example, a contactless credit card, passport, or access card) on the Zip Charger, because the RFID tag could be damaged.

Medical Device Interference

The Zip Charger contains magnets and radios that emit electromagnetic fields. These electromagnetic fields may interfere with medical devices, such as pacemakers and defibrillators. Consult your physician and medical device manufacturer for information specific to your medical device and whether you need to maintain a safe distance of separation between your medical device and the Zip Charger. If you suspect the Zip Charger is interfering with your medical device, stop using the Zip Charger.

Prolonged Heat Exposure

The Zip Charger and its cable comply with the applicable surface temperature standards and limits defined by the International Standard for Safety of Information Technology Equipment (IEC 60950-1) and the Standard for Safety of Audio/Video, Information and Communication Technology Equipment (IEC 62368-1). However, even within these limits, sustained contact with warm surfaces for long periods of time may cause discomfort or injury. Use common sense to avoid situations where your skin is in contact with the Zip Charger, the power adapter, or devices on the Zip Charger when it's operating or connected to a power source for long periods of time. For example, don't sleep on the Zip Charger, the power adapter, or devices on the Zip Charger, or place them under a blanket, pillow, or your body, when it's connected to a power source. It's important to keep the Zip Charger and the power adapter in a well-ventilated area when in use or charging. Take special care if you have a physical condition that affects your ability to detect heat against the body.

Exposure to Radio Frequency Energy

The radiated output power of the Zip Charger meets applicable radio frequency exposure limits. The Zip Charger should be operated with a minimum separation distance of 20 cm (8 inches) between the Zip Charger, or any devices on the Zip Charger, and a person's body.

Zip Charger



Super Fast Wireless smartphone charger

TECHNICAL SPECIFICATIONS

Uses Magsafe technology, compatible with smartphones with Qi technology. If your smartphone does not support fast charging, it will be charged at 5 Watt speed. Charges through most non metallic cases with a maximum thickness of 3mm/0.12"

Model : Zip Charger

Input : 5V=2A, 9V=2A, 12V=1.67A

Wireless Charging Output : maximum 15 Watt

Operating Temperature: 0-35°C (32-95°F)

Quick Charge 2.0/3.0, Power Delivery PD2.0/3.0

required for fast charge mode.

Recommended: 20W USB Power Adapter

USB 2.0 is the minimum requirement

INSTRUCTIONS FOR USE:

Connect the cable to Zip Charger and place the phone with the screen facing upwards on the centre of Zip Charger, where the charging coil centre (a) is located. The smartphone will start charging after a few seconds.

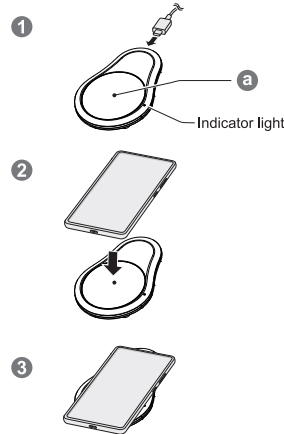

Do not place foreign materials, such as metal objects, magnets, and magnetic stripe cards, between the mobile device, and the wireless charger.
The wireless charger is compatible with USB PD and Quick charger (15W and higher).
You can remove your smartphone at any time during charging.



Indicator light identification

Connect the charger	blue and red alternately blinking 5 times
Standby	light off
Charging	red light on
Fully charge	blue light on
Foreign object detection or need to adjust the position of the device until red light not flashing	red flashing
Overheat protection	purple flashing
Undervoltage protection	red and purple alternately flashing
Overvoltage protection	blue flashing

Regulatory Compliance Information

FCC Compliance

This device complies with part 15 of the FCC Rules. Operation is subject to the following two conditions: (1) this device may not cause harmful interference, and (2) this device must accept any interference received, including interference that may cause undesired operation.

Note: This equipment has been tested and found to comply with the limits for a Class B digital device, pursuant to part 15 of the FCC Rules. These limits are designed to provide reasonable protection against harmful interference in a residential installation.

This equipment generates, uses, and can radiate radio frequency energy and, if not installed and used in accordance with the instructions, may cause harmful interference to radio communications. However, there is no guarantee that interference will not occur in a particular installation.

Changes or modifications to this product not authorized by Thinking Gifts Company could void the electromagnetic compatibility (EMC) and wireless compliance and negate your authority to operate the product.

This product has demonstrated EMC compliance under conditions that included the use of compliant peripheral devices and shielded cables between system components. It is important that you use compliant peripheral devices and shielded cables between system components to reduce the possibility of causing interference to radios, televisions, and other electronic devices.

Responsible party (contact for FCC matters only):

Thinking Gifts Company Limited
First Floor, 85 Great Portland Street, London, W1W 7LT, U.K.

Disposal and Recycling Information



The symbol above indicates that this product and/or battery should not be disposed of with household waste. When you decide to dispose of this product and/or its battery, do so in accordance with local environmental laws and guidelines.

RF exposure statement:

The equipment complies with IC Radiation exposure limit set forth for uncontrolled environment. This equipment should be installed and operated with minimum distance 10cm between the radiator and your body.

CE

This device was tested for typical body-worn operations. To comply with RF exposure requirements, a minimum separation distance of 20cm must be maintained between the user's body and the handset, including the antenna. Third-party belt-clips, holsters, and similar accessories used by this device should not contain any metallic components. Body-worn accessories that do not meet these requirements may not comply with RF exposure requirements and should be avoided. Use only the supplied or an approved antenna. This device in compliance with the essential requirements and other relevant provisions of Directive 2014/53/ EU. All essential radio test suites have been carried out. The device complies with RF specifications when the device used at 20cm from your body.

UKCA

This device was tested for operations. To comply with RF exposure requirements, a minimum separation distance of 20cm must be maintained between the user's body and the handset, including the antenna. Third-party belt-clips, holsters, and similar accessories used by this device should not contain any metallic components. Body-worn accessories that do not meet these requirements may not comply with RF exposure requirements and should be avoided. Use only the supplied or an approved antenna.

Safety and Handling

WARNING: Failure to follow these safety instructions could result in fire, electric shock, injury, or damage to the Zip Charger or other property. Read all the safety information below before using the Zip Charger.

Liquid Exposure

Keep the Zip Charger away from sources of liquid, such as drinks, oils, lotions, sinks, bathtubs, and shower stalls. Protect the Zip Charger from dampness, humidity, or wet weather, such as rain, snow, and fog.

Power

Provide power to the Zip Charger using third-party power adapters that are compliant with applicable country regulations and international and regional safety standards, including the Standard for Safety of Information Technology Equipment (IEC 60950-1) and the Standard for Safety of Audio/Video, Information and Communication Technology Equipment (IEC 62368-1). Other adapters may not meet applicable safety standards, and using them could pose a risk of death or injury.

Recommended Power Adapter Specifications

- Frequency: 50 to 60 Hz, single phase
- Line Voltage: 100 to 240 VAC
- Output Voltage/Current: 9V=2A, 12V=1.67A
- Minimum Power Output: 20W
- Output Port: USB-A, USB-C

Don't use the Zip Charger or the power adapter in wet locations, such as near a sink, bathtub, or shower stall, and don't connect or disconnect them with wet hands. Disconnect the Zip Charger, its cable, and the power adapter if any of the following conditions exists: You want to clean the Zip Charger or the power adapter; the power cord or plug becomes frayed or otherwise damaged; the Zip Charger, its cable, or the power adapter is exposed to rain, excessive moisture, or liquid; or the Zip Charger, its cable, or the power adapter has been dropped, damaged, or you suspect that service or repair is required. When you use the USB-C power adapter, make sure the cable is fully inserted into the power adapter before you plug the adapter into a power outlet.